

EH-30412-000

SHT 1.1

NOTES:

- 1 A POSITIVE GOING VOLTAGE AT TERMINAL 2, RELATIVE TO TERMINAL 1, CAUSES A DECREASE IN PRESSURE AT THE SOUND OUTLET.
- 2 LOCATED FROM TWO SURFACES FOR CUSTOMER CONVENIENCE. ONLY APPLICABLE FROM ONE SURFACE, NOT TO BE USED TOGETHER.

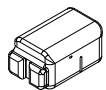
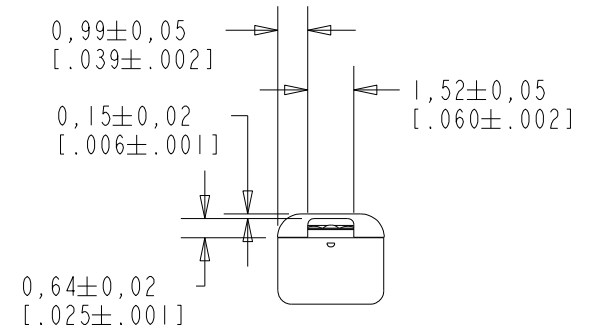
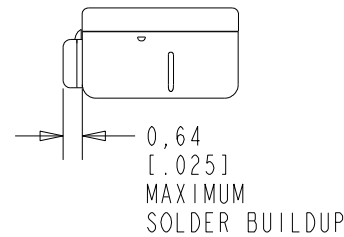
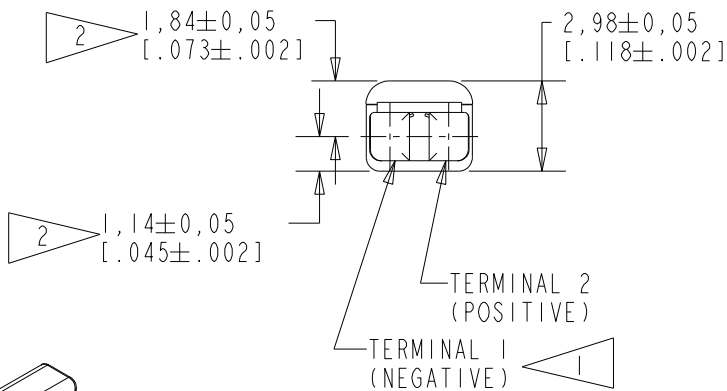
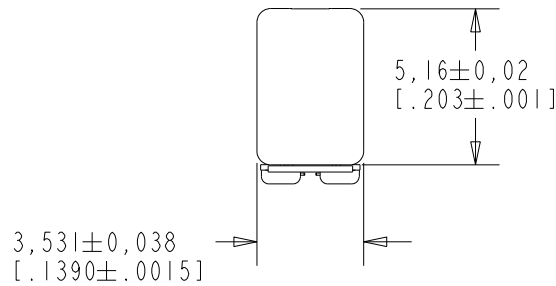

SCALE 2:1

NOMINAL WEIGHT
.23 GRAMS

DIMENSIONS IN MILLIMETERS [INCHES]

KNOWLES CORPORATION

Revision	C.O. #	Implementation Date	RELEASE LEVEL	REVISION
B	PI0000990	11-25-16	Active	B
A	CI0109284	4-2-09		

SCALE: 4:1		DR. BY	DATE
DO NOT SCALE DRAWING		MMM	4-2-09
TITLE: RECEIVER		CK. BY	DATE
OUTLINE DRAWING		GJP	4-20-09
EH-30412-000		APP. BY	DATE
SHT 1.1		GJP	4-20-09

THE EH-30412-000 IS AN UNDAMPED MAGNETIC BALANCED ARMATURE RECEIVER.

NO DAMPING

EH-30412-000

SHEET 2.1

CONSTANT VOLTAGE DRIVE CONDITIONS

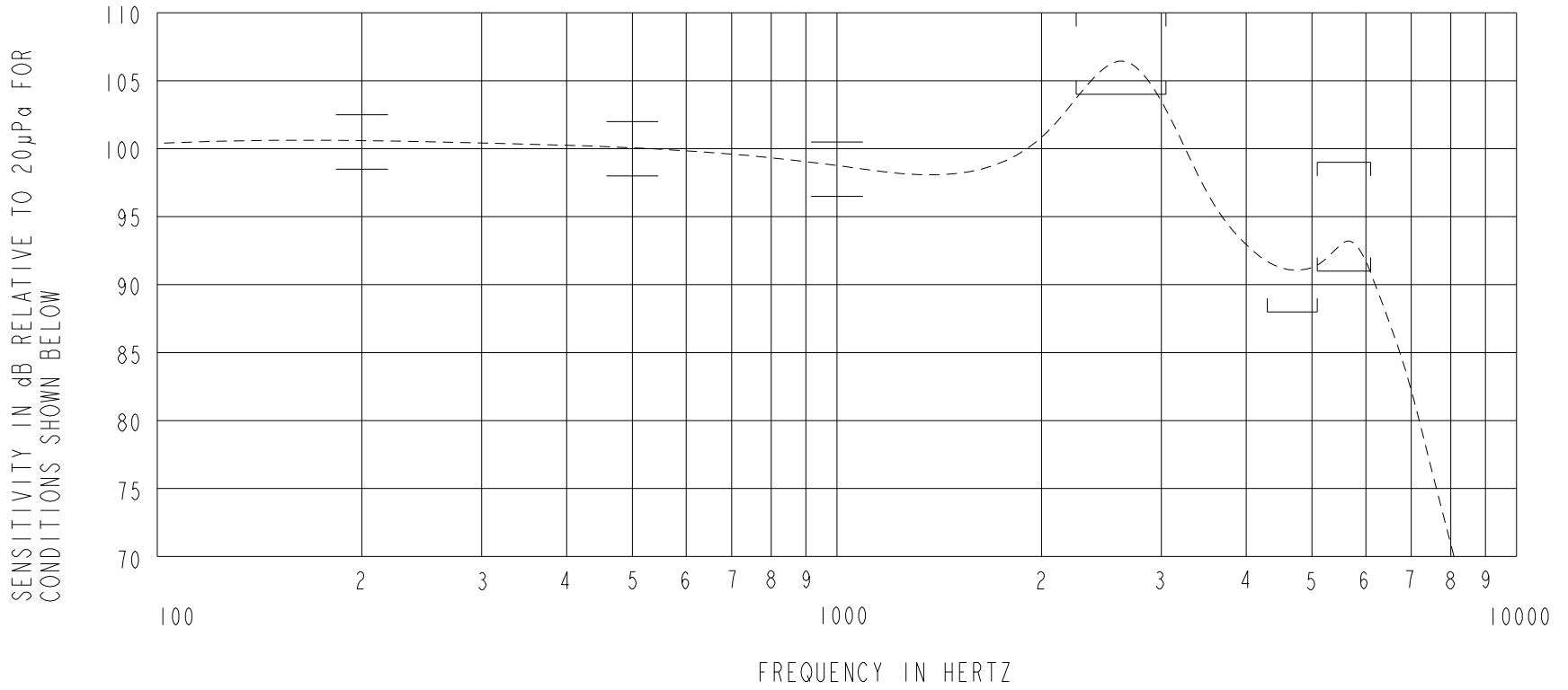

ACOUSTICAL

SENSITIVITY
DEVICE WILL PRODUCE THE SPL LISTED BELOW UNDER TEST CONDITIONS DESCRIBED IN TABLE 3.
NOMINAL SENSITIVITY AT 1kHz IS dB RELATIVE TO 20µPa. ALL OTHER VALUES
IN dB RELATIVE TO THE SENSITIVITY AT 1kHz.

FREQUENCY (Hz)	MINIMUM	NOMINAL	MAXIMUM
200	0.0	+2.0	+4.0
500	-0.5	+1.5	+3.5
1000	-2.0	98.5	+2.0
2250 - 3050	+5.5	+8.5	+11.5
4300 - 5100	-10.5	---	---
5100 - 6100	-7.5	-3.5	+0.5

PORT LOCATION: 12N

TABLE 1
TOTAL HARMONIC DISTORTION
DEVICE WILL NOT EXCEED TOTAL HARMONIC DISTORTION LEVELS LISTED BELOW.

FREQUENCY (Hz)	AC DRIVE (V rms)	DC BIAS (V)	LIMIT (%)
883	0.24	0	5
883	0.68	0	10
1325	0.24	0	5
1325	0.68	0	10

TABLE 2
TEST CONDITIONS

NOMINAL SOURCE VOLTAGE	0.24 V rms, 0 mA DC BIAS
SOURCE IMPEDANCE	<1 Ohm
TUBING	10mm [.394"] LONG, 1mm [.039"] I.D.
COUPLER CAVITY	2 CM ³ , SIMULATED ANSI S3.7 TYPE HA-3 (IEC 60318-5)

TABLE 3
ELECTRICAL

DC RESISTANCE	120 Ohms ± 10%
IMPEDANCE @ 500 Hz	147 Ohms ± 15%
IMPEDANCE @ 1kHz	191 Ohms ± 15%

TABLE 4
ISOLATION: CASE WILL BE ELECTRICALLY ISOLATED FROM THE COIL CIRCUIT.

Revision	C.O. #	Implementation Date	RELEASE LEVEL	REVISION
B	PI0000990	11-25-16	Active	B
A	CI0109284	4-2-09		

KNOWLES CORPORATION

WHEN TEST LIMITS ARE USED TO ESTABLISH INCOMING INSPECTION ACCEPTANCE/REJECTION CRITERIA, CORRELATION OF TEST EQUIPMENT WITH KNOWLES IS ALSO REQUIRED FOR ELIMINATION OF EQUIPMENT AND TEST METHOD VARIATION

TITLE: RECEIVER
PERFORMANCE SPECIFICATION

EH-30412-000
SHT 2.1

DR. BY	DATE
MMM	4-2-09
CK. BY	DATE
GJP	4-20-09
APP. BY	DATE
GJP	4-20-09